

PLOT NO 9B HAS BEEN ALLOTTED TO INTERNATIONAL MEDICAL SCIENCE ACADEMY (IMSIA) VIDE LETTER NO-F 12 (12A) 2000/IL/2362 DATED 6.12.12 AT PAGE NO 202/C IN FILE NO. F 3 (3A) 2010/MP.



**DELHI DEVELOPMENT AUTHORITY**

Details regarding plot size, development control norms, set backs:-

Plot No.	Area (sq.m)	Proposed to be Sub-divided	Area in sq.m
9	2080	(i) 9-A (ii) 9-B (iii) 9-C	500 (20 X 25 m) 500 (20 X 25 m) 1080 (27 X 40 m)



**SITE PLAN**

Sl. No	Set backs				Development Control norms
	Front (m)	Rear (m)	Side (m)	Side (m)	
(i) 4	3	3	-	-	For plot no. 9-A & 9-B i.e. 500 sq.m. as per MPD 2021 norms for smaller plots.
(ii) 4	3	3	-	-	
(iii) 6	3	3	3	3	For plot no. 9-C As per MPD-2021 norms.

- NOTES:-
- DO NOT SCALE THE DRAWING. WRITTEN DIMENSIONS TO BE FOLLOWED.
  - IN CASE OF ANY DISCREPANCY THE SAME BE BROUGHT TO THE NOTICE OF DIR. (PLG) NARELA.
  - NECESSARY PERMISSION SHALL BE TAKEN FROM THE CONCERNED DEPARTMENT FOR CUTTING OF TREES.
  - MASTER PLAN FILE NO. FOR SECTOR A-7 NARELA IS F3(34)2010/MP.

NOTE:-  
APPROVED BY 303rd SCREENING COMMITTEE HELD ON 21.12.2011 VIDE ITEM NO. 113:2011 IN FILE NO. F3(34)2010/MP

To Narela Village

ROAD 40 M R/W

To UERI (80 M R/W) Road

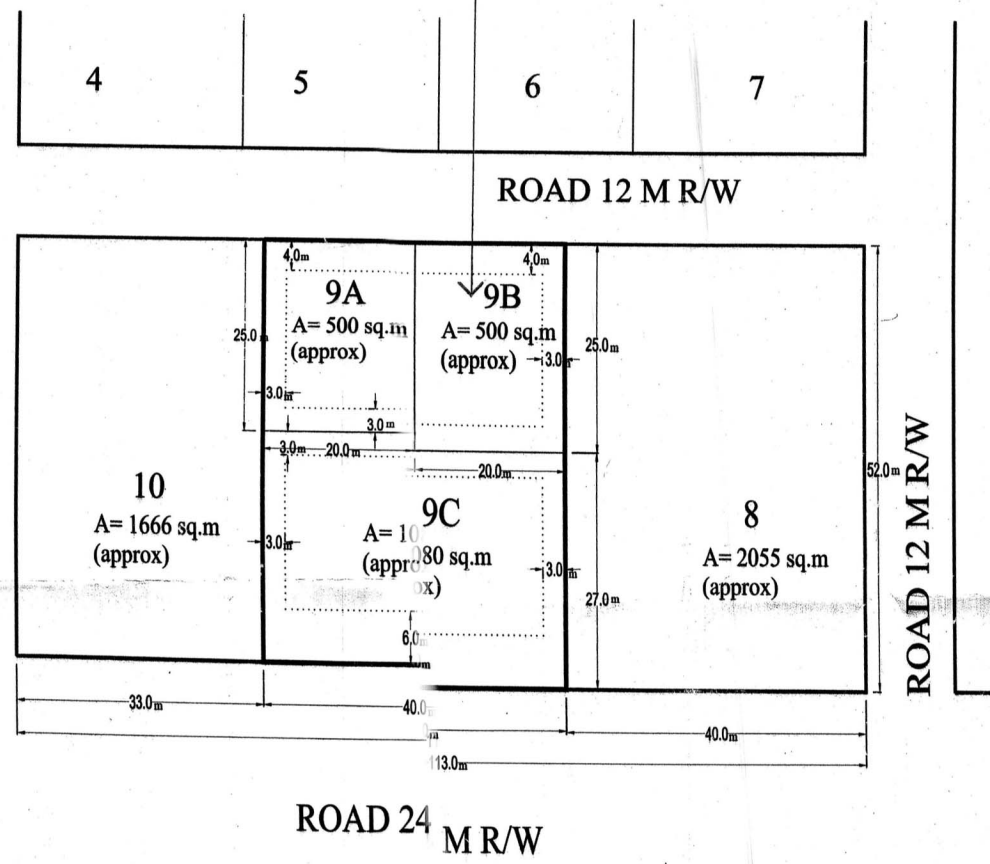

DELHI DEVELOPMENT AUTHORITY  
Screening Committee  
Approved in 303rd Meeting on 21.12.2011  
Meeting Held on 21.12.2011  
Director (Plg.)

DELHI DEVELOPMENT AUTHORITY  
HUPA  
This project was approved by the Screening Committee on 21.12.2011  
Meeting held on 21.12.2011  
vide Item No. 113:2011  
Director (Arch.) Coord

PART PLAN OF LOP, SECTOR A-7, NARELA

SUB-DIVISION OF PLOT NO. 9, PUBLIC & SEMI PUBLIC FACILITY AREA, SECTOR A-7 (FA-2), NARELA

SCALE 1:500

PLG ASST	ASST. DIR.	JOINT. DIR. (PLG)	DRAWING NO. 272/P-3
DIR. (PLG)	ADL. COMM. (PLG.)	COMMISSIONER (PLG)-II	

**NARELA PROJECT**